

# Ручные приводы серии SRH

## Технические характеристики



Архангельск (8182)63-90-72  
Астана (7172)727-132  
Астрахань (8512)99-46-04  
Барнаул (3852)73-04-60  
Белгород (4722)40-23-64  
Брянск (4832)59-03-52  
Владивосток (423)249-28-31  
Волгоград (844)278-03-48  
Вологда (8172)26-41-59  
Воронеж (473)204-51-73  
Екатеринбург (343)384-55-89  
Иваново (4932)77-34-06

Ижевск (3412)26-03-58  
Иркутск (395)279-98-46  
Казань (843)206-01-48  
Калининград (4012)72-03-81  
Калуга (4842)92-23-67  
Кемерово (3842)65-04-62  
Киров (8332)68-02-04  
Краснодар (861)203-40-90  
Красноярск (391)204-63-61  
Курск (4712)77-13-04  
Липецк (4742)52-20-81  
Киргизия (996)312-96-26-47

Магнитогорск (3519)55-03-13  
Москва (495)268-04-70  
Мурманск (8152)59-64-93  
Набережные Челны (8552)20-53-41  
Нижний Новгород (831)429-08-12  
Новокузнецк (3843)20-46-81  
Новосибирск (383)227-86-73  
Омск (3812)21-46-40  
Орел (4862)44-53-42  
Оренбург (3532)37-68-04  
Пенза (8412)22-31-16  
Казахстан (772)734-952-31

Пермь (342)205-81-47  
Ростов-на-Дону (863)308-18-15  
Рязань (4912)46-61-64  
Самара (846)206-03-16  
Санкт-Петербург (812)309-46-40  
Саратов (845)249-38-78  
Севастополь (8692)22-31-93  
Симферополь (3652)67-13-56  
Смоленск (4812)29-41-54  
Сочи (862)225-72-31  
Ставрополь (8652)20-65-13  
Таджикистан (992)427-82-92-69

Сургут (3462)77-98-35  
Тверь (4822)63-31-35  
Томск (3822)98-41-53  
Тула (4872)74-02-29  
Тюмень (3452)66-21-18  
Ульяновск (8422)24-23-59  
Уфа (347)229-48-12  
Хабаровск (4212)92-98-04  
Челябинск (351)202-03-61  
Череповец (8202)49-02-64  
Ярославль (4852)69-52-93

Единый адрес для всех регионов: [bya@nt-rt.ru](mailto:bya@nt-rt.ru) | [www.bray.nt-rt.ru](http://www.bray.nt-rt.ru)

# Ручные приводы серии SRH

*(Deadman Handle)*

For use with compatible 1/4" – 2" Ball Valves

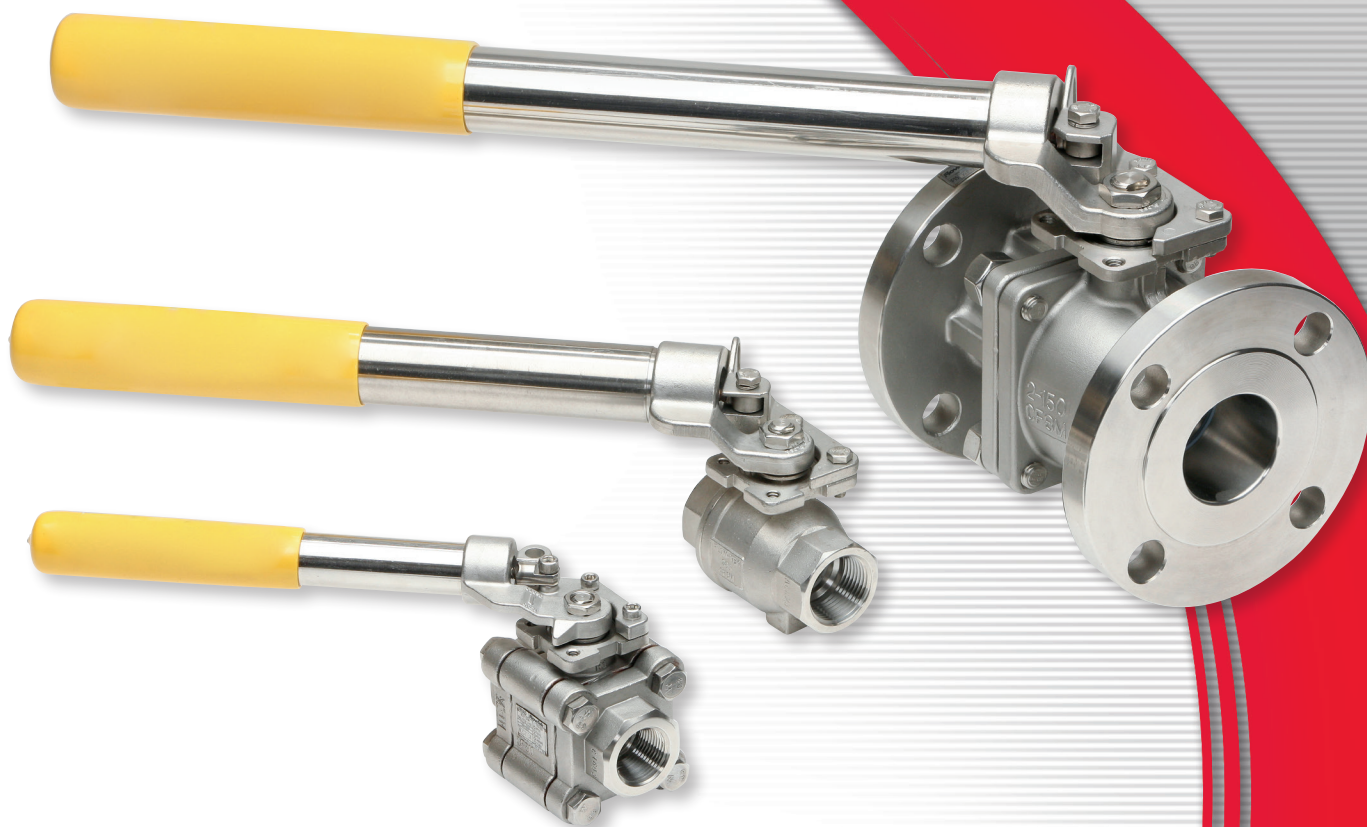

Flow-Tek's SRH Series Spring Return (Deadman) Handles are manufactured from heavy duty stainless steel components to withstand frequent daily use in refueling, sampling, drains, and other OSHA applications that require positive closure of a manual valve. Each SRH Handle has a locking device as standard to lock the valve in the preferred position. The SRH Handle is available in three sizes that mount directly to the rugged investment cast ISO 5211 mounting pads on compatible Flow-Tek full or standard port industrial ball valves.

All compatible Flow-Tek valves utilize live loaded packing which provides longer periods between packing adjustment and maintenance, reducing the need to remove the SRH handle for valve maintenance.

Each SRH Handle can be easily retrofitted on existing Flow-Tek lever operated ball valves provided one follows the compatibility chart shown on page 2.

# SRH Series Spring Return Handle

## (Deadman Handle)

For use with compatible 1/4" – 2" Ball Valves

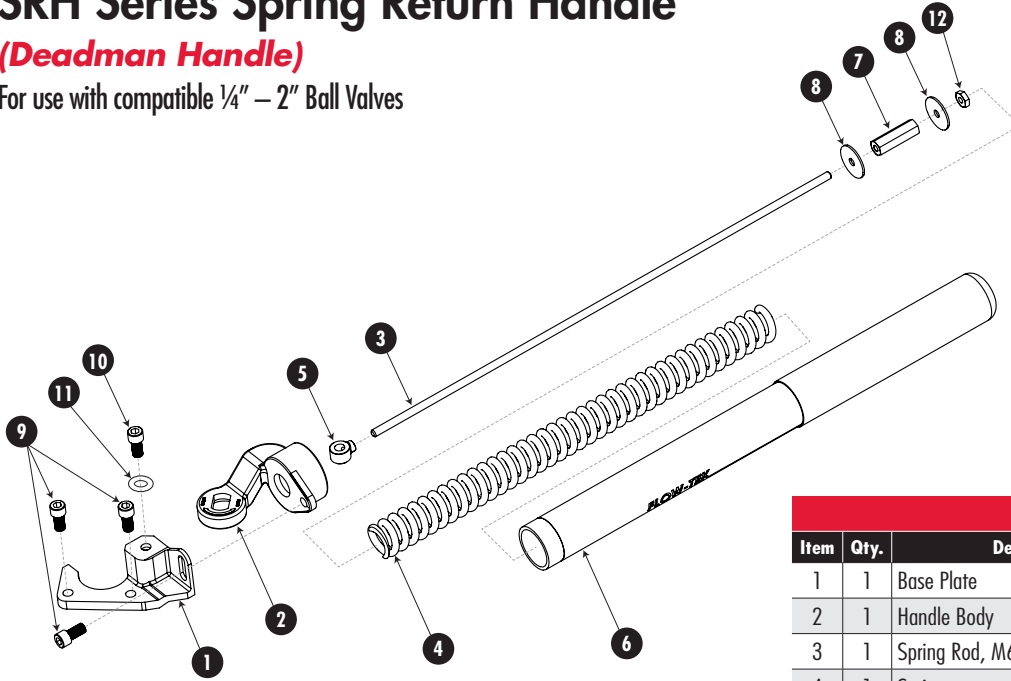

| Spring Return Handle Model # | Handle Length | Handle Weight (lbs) |
|------------------------------|---------------|---------------------|
| SRH1                         | 10.47"        | 2.25                |
| SRH2                         | 13.38"        | 3                   |
| SRH3                         | 19.125"       | 5.7                 |

| VALVE MODEL F15 |                            |
|-----------------|----------------------------|
| Size            | Spring Return Handle SRH # |
| 1/2"            | 1                          |
| 3/4"            | 1                          |
| 1"              | 2                          |
| 1 1/2"          | 3                          |
| 2"              | 3                          |

| VALVE MODEL RF15/RF30 |  |
|-----------------------|--|
| Size                  | Spring Return Handle SRH #                               |
| 1"                    | 1 Handle mounted one side only (lock on the insert side) |
| 1 1/2"                | 2 Handle mounted one side only (lock on the insert side) |
| 2"                    | 3 Handle mounted one side only (lock on the insert side) |

| Parts List |      |                                |                         |
|------------|------|--------------------------------|-------------------------|
| Item       | Qty. | Description                    | Material                |
| 1          | 1    | Base Plate                     | CF8M                    |
| 2          | 1    | Handle Body                    | CF8M                    |
| 3          | 1    | Spring Rod, M6                 | Stainless Steel 304     |
| 4          | 1    | Spring                         | Carbon Steel Music Wire |
| 5          | 1    | Rod Clevis                     | CF8M                    |
| 6          | 1    | Handle                         | Stainless Steel         |
| 7          | 1    | Spring Nut, M6 x .38"          | Stainless Steel 304     |
| 8          | 2    | Spring Washer 5/16 x 27 x 1.5" | Stainless Steel 304     |
| 9          | 3    | Hex Cap Screw 5/16 x 18 x 3/4" | Stainless Steel 304     |
| 10         | 1    | Hex Cap Screw M8 x 20mm        | Stainless Steel 304     |
| 11         | 1    | 8mm Lock Washer                | Stainless Steel 304     |
| 12         | 1    | M6 Hex Nut                     | Stainless Steel 304     |

| VALVE MODEL F30 |   |
|-----------------|---|
| Size            | Spring Return Handle SRH #                            |
| 1/2"            | 1 Handle mounted one side only (lock on the cap side) |
| 3/4"            | 1 Handle mounted one side only (lock on the cap side) |
| 1"              | 2 Handle mounted one side only (lock on the cap side) |
| 1 1/2"          | 3 Handle mounted one side only (lock on the cap side) |
| 2"              | 3   |

| VALVE MODEL S85 |                            |
|-----------------|----------------------------|
| Size            | Spring Return Handle SRH # |
| 1/2"            | 1                          |
| 3/4"            | 1                          |
| 1"              | 2                          |
| 1 1/4"          | 2                          |
| 1 1/2"          | 3                          |
| 2"              | 3                          |

| VALVE MODEL 7000/8000 |                            |
|-----------------------|----------------------------|
| Size                  | Spring Return Handle SRH # |
| 1/4"                  | 1                          |
| 3/8"                  | 1                          |
| 1/2"                  | 1                          |
| 3/4"                  | 1                          |
| 1"                    | 2                          |
| 1 1/4"                | 2                          |
| 1 1/2"                | 3                          |
| 2"                    | 3                          |

| VALVE MODEL TRIAD FP |                            |
|----------------------|----------------------------|
| Size                 | Spring Return Handle SRH # |
| 1/4"                 | 1                          |
| 3/8"                 | 1                          |
| 1/2"                 | 1                          |
| 3/4"                 | 1                          |
| 1"                   | 3                          |
| 1 1/4"               | 3                          |

| VALVE MODEL TRIAD SP |                            |
|----------------------|----------------------------|
| Size                 | Spring Return Handle SRH # |
| 3/4"                 | 1                          |
| 1"                   | 1                          |
| 1 1/4"               | 3                          |
| 1 1/2"               | 3                          |

Архангельск (8182)63-90-72  
Астана (7172)727-132  
Астрахань (8512)99-46-04  
Барнаул (3852)73-04-60  
Белгород (4722)40-23-64  
Брянск (4832)59-03-52  
Владивосток (423)249-28-31  
Волгоград (844)278-03-48  
Вологда (8172)26-41-59  
Воронеж (473)204-51-73  
Екатеринбург (343)384-55-89  
Иваново (4932)77-34-06  
Ижевск (3412)26-03-58  
Иркутск (395)279-98-46  
Казань (843)206-01-48  
Калининград (4012)72-03-81  
Калуга (4842)92-23-67  
Кемерово (3842)65-04-62  
Киров (8332)68-02-04  
Краснодар (861)203-40-90  
Красноярск (391)204-63-61  
Курск (4712)77-13-04  
Липецк (4742)52-20-81  
Киргизия (996)312-96-26-47  
Магнитогорск (3519)55-03-13  
Москва (495)268-04-70  
Мурманск (8152)59-64-93  
Набережные Челны (8552)20-53-41  
Нижний Новгород (831)429-08-12  
Новокузнецк (3843)20-46-81  
Новосибирск (383)227-86-73  
Омск (3812)21-46-40  
Орел (4862)44-53-42  
Оренбург (3532)37-68-04  
Пенза (8412)22-31-16  
Казахстан (772)734-952-31  
Пермь (342)205-81-47  
Ростов-на-Дону (863)308-18-15  
Рязань (4912)46-61-64  
Самара (846)206-03-16  
Санкт-Петербург (812)309-46-40  
Саратов (845)249-38-78  
Севастополь (8692)22-31-93  
Симферополь (3652)67-13-56  
Смоленск (4812)29-41-54  
Сочи (862)225-72-31  
Ставрополь (8652)20-65-13  
Таджикистан (992)427-82-92-69  
Сургут (3462)77-98-35  
Тверь (4822)63-31-35  
Томск (3822)98-41-53  
Тула (4872)74-02-29  
Тюмень (3452)66-21-18  
Ульяновск (8422)24-23-59  
Уфа (347)229-48-12  
Хабаровск (4212)92-98-04  
Челябинск (351)202-03-61  
Череповец (8202)49-02-64  
Ярославль (4852)69-52-93

Единый адрес для всех регионов: [bya@nt-rt.ru](mailto:bya@nt-rt.ru) | | [www.bray.nt-rt.ru](http://www.bray.nt-rt.ru)