

Краны шаровые резьбовые серии S85

Технические характеристики



Архангельск (8182)63-90-72
Астана (7172)727-132
Астрахань (8512)99-46-04
Барнаул (3852)73-04-60
Белгород (4722)40-23-64
Брянск (4832)59-03-52
Владивосток (423)249-28-31
Волгоград (844)278-03-48
Вологда (8172)26-41-59
Воронеж (473)204-51-73
Екатеринбург (343)384-55-89
Иваново (4932)77-34-06

Ижевск (3412)26-03-58
Иркутск (395)279-98-46
Казань (843)206-01-48
Калининград (4012)72-03-81
Калуга (4842)92-23-67
Кемерово (3842)65-04-62
Киров (8332)68-02-04
Краснодар (861)203-40-90
Красноярск (391)204-63-61
Курск (4712)77-13-04
Липецк (4742)52-20-81
Киргизия (996)312-96-26-47

Магнитогорск (3519)55-03-13
Москва (495)268-04-70
Мурманск (8152)59-64-93
Набережные Челны (8552)20-53-41
Нижний Новгород (831)429-08-12
Новокузнецк (3843)20-46-81
Новосибирск (383)227-86-73
Омск (3812)21-46-40
Орел (4862)44-53-42
Оренбург (3532)37-68-04
Пенза (8412)22-31-16
Казахстан (772)734-952-31

Пермь (342)205-81-47
Ростов-на-Дону (863)308-18-15
Рязань (4912)46-61-64
Самара (846)206-03-16
Санкт-Петербург (812)309-46-40
Саратов (845)249-38-78
Севастополь (8692)22-31-93
Симферополь (3652)67-13-56
Смоленск (4812)29-41-54
Сочи (862)225-72-31
Ставрополь (8652)20-65-13
Таджикистан (992)427-82-92-69

Сургут (3462)77-98-35
Тверь (4822)63-31-35
Томск (3822)98-41-53
Тула (4872)74-02-29
Тюмень (3452)66-21-18
Ульяновск (8422)24-23-59
Уфа (347)229-48-12
Хабаровск (4212)92-98-04
Челябинск (351)202-03-61
Череповец (8202)49-02-64
Ярославль (4852)69-52-93

Единый адрес для всех регионов: bya@nt-rt.ru | www.bray.nt-rt.ru

Краны шаровые резьбовые серии S85

Flow-Tek's Series S85 ball valves have been designed for ease of automation. Standard 2-piece valve bodies are investment cast Stainless Steel, solution annealed for the highest quality and added strength. All body castings are marked with a foundry heat number for full traceability.

These valves offer quarter turn operation and low operating torque. The S85 features live-loaded, self-adjusting stem seals that automatically adjust packing to

compensate for changes in wear and temperature. Other features include replaceable seats and seals, anti-static devices, blowout proof stems, and stainless steel safety latch handles.

Secure Mount: The Series S85 features Flow-Tek's Secure Mount integrally cast actuator mounting pad. The Secure Mount fully complies with ISO 5211, ensuring positive alignment and interchangeability of the actuator.



| Size | Pressure Rating | Steam Rating | Temperature Range | End Connections | Body Material |
|----------|-----------------|--------------|------------------------------------|-----------------|-----------------|
| ½" to 3" | 1000 psi WOG | 150 psi WSP | -50°F to +450°F -46°C to +232°C | Threaded - NPT | Stainless Steel |

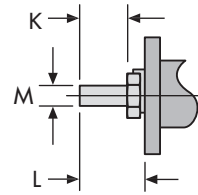
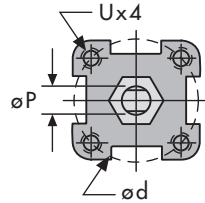
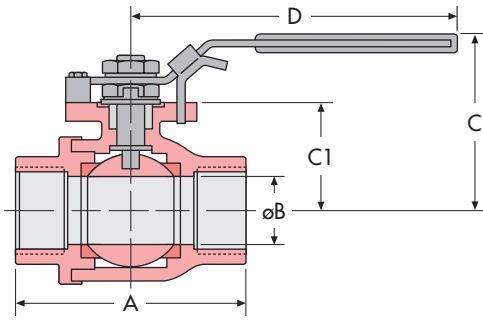

Verify mounting dimensions before manufacturing mounting hardware.

Dimensions

| Size ins mm | A | øB Port | C | C1 | D | ød | K | L | M | øP | U UNC | Cv | Torque lbs-in.*. mm | Weight lbs. kg |
|----------------|---------------|--------------|---------------|---------------|---------------|-------------|--------------|--------------|-------------|--------------|----------|------|------------------------|-------------------|
| 1/2 15 | 2.56 65 | 0.59 15 | 2.52 64 | 1.13 28.7 | 6.50 165.1 | 1.65 42 | 0.35 9 | 0.65 16.5 | 0.25 6.4 | 0.37 9.4 | #10-24 | 38 | 60 7 | 0.65 0.3 |
| 3/4 20 | 2.99 76 | 0.79 20.1 | 2.80 71 | 1.40 35.5 | 6.50 165.1 | 1.65 42 | 0.35 9 | 0.65 16.5 | 0.25 6.4 | 0.37 6.4 | #10-24 | 66 | 96 11 | 1.45 0.7 |
| 1 25 | 3.46 87.9 | 0.98 25 | 3.11 79 | 1.61 41 | 7.87 200 | 1.97 50 | 0.55 14 | 0.87 22 | 0.32 8 | 0.43 10.9 | 1/4"-20 | 105 | 140 16 | 2.36 1.1 |
| 1 1/4 32 | 3.82 97 | 1.26 32 | 3.66 93 | 2.16 54.95 | 7.87 200 | 1.97 50 | 0.55 14 | 0.97 20 | 0.32 8 | 0.43 10.9 | 1/4"-20 | 190 | 195 22 | 3.50 1.6 |
| 1 1/2 40 | 4.33 110 | 1.50 38.1 | 3.94 100.1 | 2.28 58 | 9.84 249.9 | 2.76 70 | 0.59 15 | 1.02 26 | 0.37 9.5 | 0.62 15.8 | 5/16"-18 | 275 | 315 36 | 4.85 2.2 |
| 2 50 | 5.28 134.1 | 2.00 50.8 | 4.25 108 | 2.60 66 | 9.84 249.9 | 2.76 70 | 0.59 15 | 1.02 26 | 0.37 9.5 | 0.62 15.8 | 5/16"-18 | 480 | 510 58 | 7.30 3.3 |
| 2 1/2 65 | 6.18 157 | 2.56 65 | 5.00 127 | 3.39 86 | 9.65 245.1 | 4.02 102 | 0.75 19 | 1.14 29 | 0.47 12 | 0.75 19.1 | 5/16"-18 | 797 | 800 91 | 13.5 6.1 |
| 3 80 | 7.52 191 | 2.99 76 | 5.71 145 | 3.94 100 | 5.98 151.9 | 4.02 102 | 0.88 22.4 | 1.28 32.5 | 0.47 12 | 0.75 11.9 | 5/16"-18 | 1150 | 1100 125 | 25.3 11.5 |

*Based on RPTFE seats at full rated pressure.

Pressure / Temperature

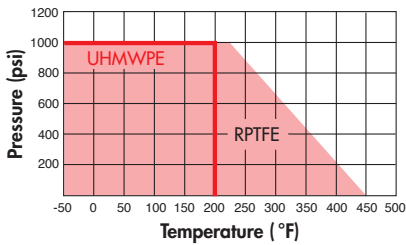

Steam Rating: 150 psi WSP

- All Series S85 valves comply with: MSS-SP 110, NACE MR0175
- All valves are tested in accordance with MSS-SP 110.
- Vacuum Service to 29 inches Hg.

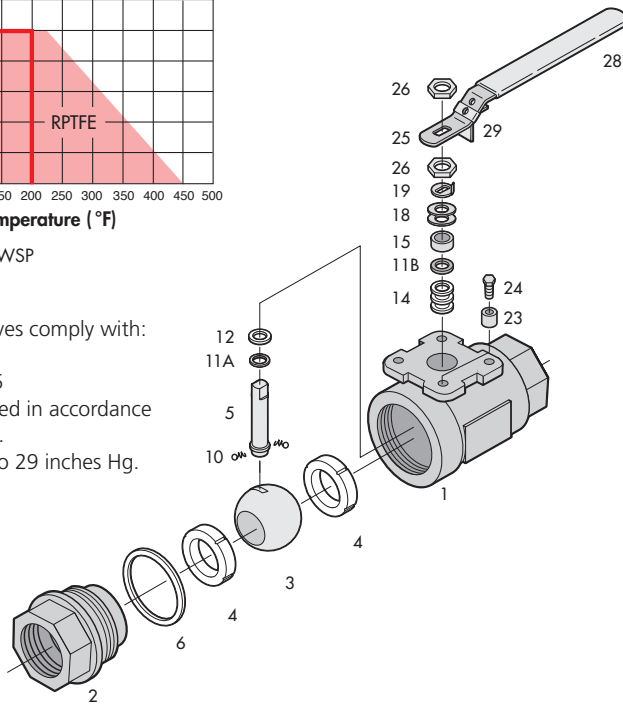

Components & Materials

| Item | Name | Material | Qty. |
|--------|--------------------|--------------------|------|
| 1 | Body | ASTM A351 Gr CF8M | 1 |
| 2 | End Cap | ASTM A351 Gr CF8M | 1 |
| 3 | Ball | ASTM A351 Gr CF8M | 1 |
| 4 | Seat* | RPTFE | 2 |
| 5 | Stem | ASTM A479 Type 316 | 1 |
| 6 | Body Seal* | RPTFE | 1 |
| 10 | Anti-Static Device | SS304 | 2 |
| 11 A/B | Thrust Bearing* | PEEK | 1/1 |
| 12 | Thrust Washer* | 50% PTFE + 50% 316 | 1 |
| 14 | Stem Packing* | PTFE/RPTFE | 4 |
| 15 | Packing Gland | SS304 | 1 |
| 18 | Belleve Washer | SS301 | 2 |
| 19 | Tab Lock Washer | SS304 | 1 |
| 23 | Stop Set Sleeve | SS304 | 1 |
| 24 | Stop Bolt | SS304 | 1 |
| 25 | Handle | SS304 | 1 |
| 26 | Nut | SS304 | 2 |
| 28 | Handle Sleeve | Vinyl | 1 |
| 29 | Locking Device | SS300 | 1 |

*Parts included in the repair kits

Архангельск (8182)63-90-72
Астана (7172)727-132
Астрахань (8512)99-46-04
Барнаул (3852)73-04-60
Белгород (4722)40-23-64
Брянск (4832)59-03-52
Владивосток (423)249-28-31
Волгоград (844)278-03-48
Вологда (8172)26-41-59
Воронеж (473)204-51-73
Екатеринбург (343)384-55-89
Иваново (4932)77-34-06
Ижевск (3412)26-03-58
Иркутск (395)279-98-46
Казань (843)206-01-48
Калининград (4012)72-03-81
Калуга (4842)92-23-67
Кемерово (3842)65-04-62
Киров (8332)68-02-04
Краснодар (861)203-40-90
Красноярск (391)204-63-61
Курск (4712)77-13-04
Липецк (4742)52-20-81
Киргизия (996)312-96-26-47
Магнитогорск (3519)55-03-13
Москва (495)268-04-70
Мурманск (8152)59-64-93
Набережные Челны (8552)20-53-41
Нижний Новгород (831)429-08-12
Новокузнецк (3843)20-46-81
Новосибирск (383)227-86-73
Омск (3812)21-46-40
Орел (4862)44-53-42
Оренбург (3532)37-68-04
Пенза (8412)22-31-16
Казахстан (772)734-952-31
Пермь (342)205-81-47
Ростов-на-Дону (863)308-18-15
Рязань (4912)46-61-64
Самара (846)206-03-16
Санкт-Петербург (812)309-46-40
Саратов (845)249-38-78
Севастополь (8692)22-31-93
Симферополь (3652)67-13-56
Смоленск (4812)29-41-54
Сочи (862)225-72-31
Ставрополь (8652)20-65-13
Таджикистан (992)427-82-92-69
Сургут (3462)77-98-35
Тверь (4822)63-31-35
Томск (3822)98-41-53
Тула (4872)74-02-29
Тюмень (3452)66-21-18
Ульяновск (8422)24-23-59
Уфа (347)229-48-12
Хабаровск (4212)92-98-04
Челябинск (351)202-03-61
Череповец (8202)49-02-64
Ярославль (4852)69-52-93

Единый адрес для всех регионов: bya@nt-rt.ru | | www.bray.nt-rt.ru