

Приводы пневматические модульные серии 98

Технические характеристики



Архангельск (8182)63-90-72
Астана (7172)727-132
Астрахань (8512)99-46-04
Барнаул (3852)73-04-60
Белгород (4722)40-23-64
Брянск (4832)59-03-52
Владивосток (423)249-28-31
Волгоград (844)278-03-48
Вологда (8172)26-41-59
Воронеж (473)204-51-73
Екатеринбург (343)384-55-89
Иваново (4932)77-34-06

Ижевск (3412)26-03-58
Иркутск (395)279-98-46
Казань (843)206-01-48
Калининград (4012)72-03-81
Калуга (4842)92-23-67
Кемерово (3842)65-04-62
Киров (8332)68-02-04
Краснодар (861)203-40-90
Красноярск (391)204-63-61
Курск (4712)77-13-04
Липецк (4742)52-20-81
Киргизия (996)312-96-26-47

Магнитогорск (3519)55-03-13
Москва (495)268-04-70
Мурманск (8152)59-64-93
Набережные Челны (8552)20-53-41
Нижний Новгород (831)429-08-12
Новокузнецк (3843)20-46-81
Новосибирск (383)227-86-73
Омск (3812)21-46-40
Орел (4862)44-53-42
Оренбург (3532)37-68-04
Пенза (8412)22-31-16
Казахстан (772)734-952-31

Пермь (342)205-81-47
Ростов-на-Дону (863)308-18-15
Рязань (4912)46-61-64
Самара (846)206-03-16
Санкт-Петербург (812)309-46-40
Саратов (845)249-38-78
Севастополь (8692)22-31-93
Симферополь (3652)67-13-56
Смоленск (4812)29-41-54
Сочи (862)225-72-31
Ставрополь (8652)20-65-13
Таджикистан (992)427-82-92-69

Сургут (3462)77-98-35
Тверь (4822)63-31-35
Томск (3822)98-41-53
Тула (4872)74-02-29
Тюмень (3452)66-21-18
Ульяновск (8422)24-23-59
Уфа (347)229-48-12
Хабаровск (4212)92-98-04
Челябинск (351)202-03-61
Череповец (8202)49-02-64
Ярославль (4852)69-52-93

Единый адрес для всех регионов: bya@nt-rt.ru | www.bray.nt-rt.ru

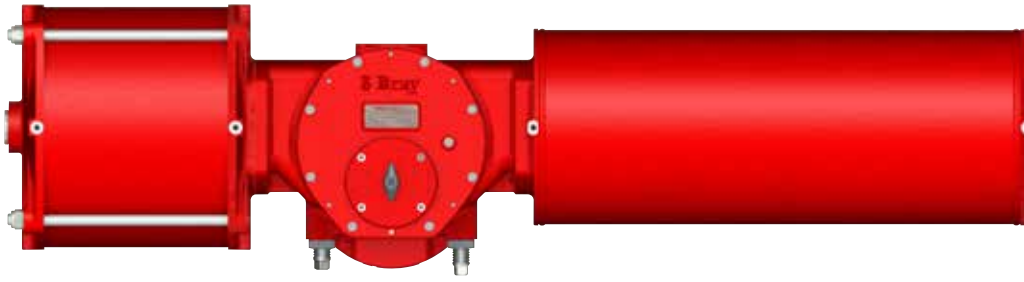

Приводы пневматические модульные серии 98

Bray's engineering excellence and precision manufacturing have produced a modular product line optimized for mounting on Bray valves. In addition all Bray accessories are fully configurable and directly mount to the actuator – providing flexibility and efficiency at reduced cost.

The Series 98 actuators were designed primarily for pneumatic operation to a maximum pressure of 150 psi (10.3 Bar) and for temperature ranges of -40°F (-40°C) to 300°F (+149°C).

- » Compact design offers a high torque to weight ratio
- » Modular Design offers easy configuration in the field
- » Module alignment ensured by precision machined centering rings
- » Torque Output ranging from 4,000 to 885,000 Lb-in (450 to 100,000 Nm)
- » Spring End Torque ranging from 575 to 44,000 Lb-in (65 to 49,720 Nm)
- » Premium epoxy/polyurethane coating as standard

Operating Conditions

Pressure Range	40 - 150 psi (2.8 - 10.3 bar)
Media	Dry Compressed Air/Inert Gas*
Temperature Range Options	Standard: -20°F to 200°F (-29°C to 93°C)
	High Temperature: Up to 300°F (149°C)*
	Low Temperature: Down to -40°F (-40°C)*

Compliances

Torque Base	Mounting Dimensions as per ISO 5211: 2001(E)
Accessories	Shaft Driven Accessories Mounting per NAMUR-VDE
Performance Testing	EN 15714-3:2009
Ingress Protection	IP66/IP67M per IEC 60529
Safety	ATEX, SIL 3 suitable, PED on request

*Contact Factory for other media or non-standard temperature range.

S98 Actuator Torque Ranges

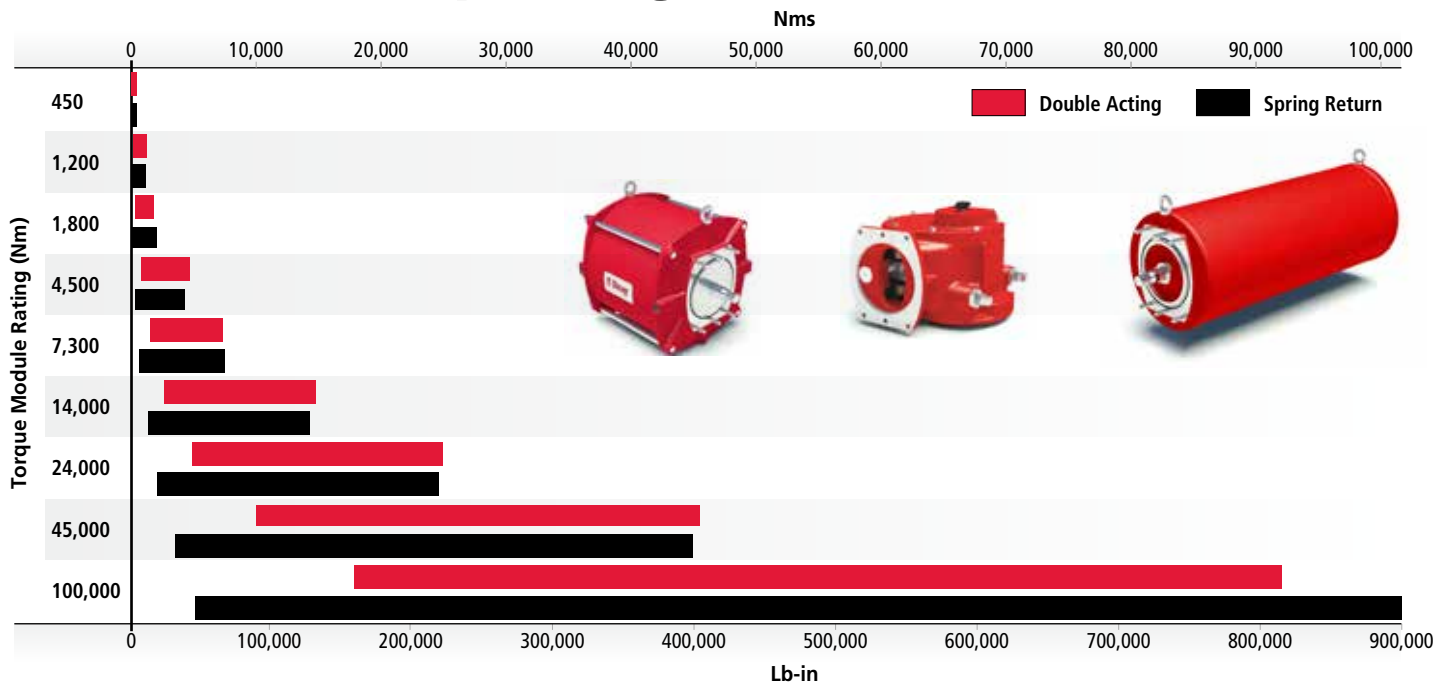

S98 Torque Modules



- » Integral single piece cast housing for rigidity
- » Two ISO drilling patterns in base to maximize direct mounting
- » Symmetrical and Canted Yoke options

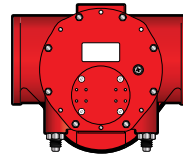

- » Integral travel stops
- » Replaceable self lubricating metal backed PTFE bearings for enhanced service life
- » NAMUR mounting for shaft driven accessories, standardized across models

- » Guided drive supports side loads
- » Relief vent prevents ingress and over pressurization

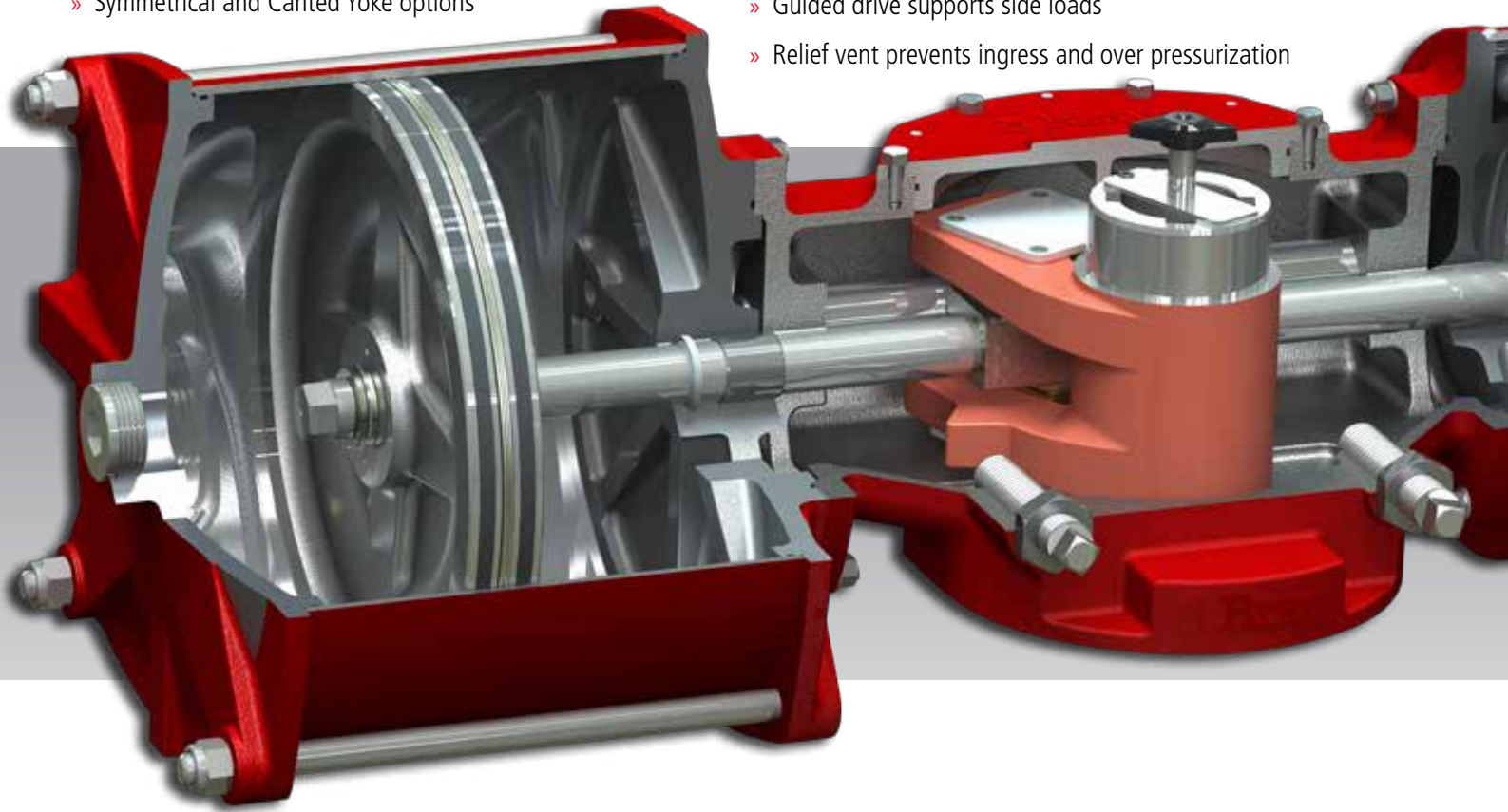

S98 Pressure Modules



- » Corrosion protected external tie rods designed for long seal life and reliability
- » Honed and hard chrome plated cylinder barrel for wear and corrosion protection and enhanced seal performance
- » Multiple ports available
- » Quad ring and U-cup seals for dynamic sealing
- » Dual wear bands for better guidance of piston

Pressure Module: Torque Module

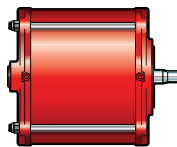

Pneumatic



Hydraulic

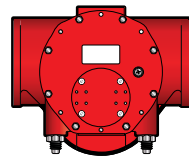

S98 Direct Acting Modules



Direct Acting Modules

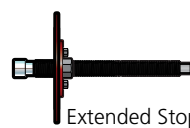

Extended Stop

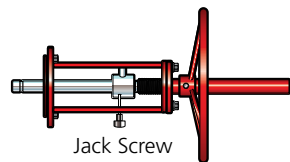

Jack Screw

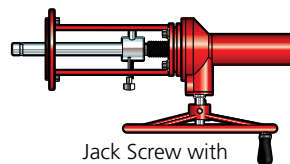

Jack Screw with Gear Drive

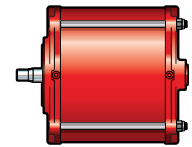

Pneumatic

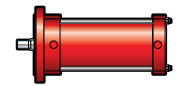

Hydraulic Override

**MODULAR
DESIGN**

Direct Mounting to Bray Valves



S98 actuator suitable for a specific application can be configured by combining modules.

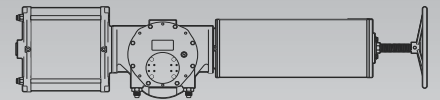
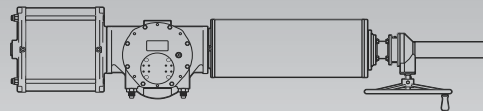
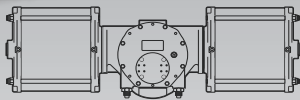

S98 Spring Modules

- » Fully enclosed and welded design for safety
- » Guided and centered springs for smooth operation
- » No metal to metal contact of spring or guide
- » Thrust base for mounting jackscrew and hydraulic override
- » Tectyl coated springs for corrosion protection

Spring Return Modules



Standard



Jackscrew Direct Drive Override



Extended Travel Stop

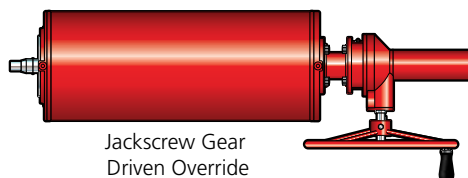

Jackscrew Gear Driven Override

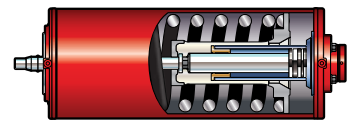

Hydraulic Override

Symmetrical & Canted Yokes



The heart of the Series 98 actuator is the scotch yoke. This mechanism converts linear motion into rotational motion. The piston and/or springs directly couple to a rotating yoke with a slot that engages the sliding blocks. This type of actuator has a distinct torque curve which starts high then dips toward the middle of the stroke and ends with increasing torque, thus offering an inherent optimization of torque requirements associated with many valve applications.

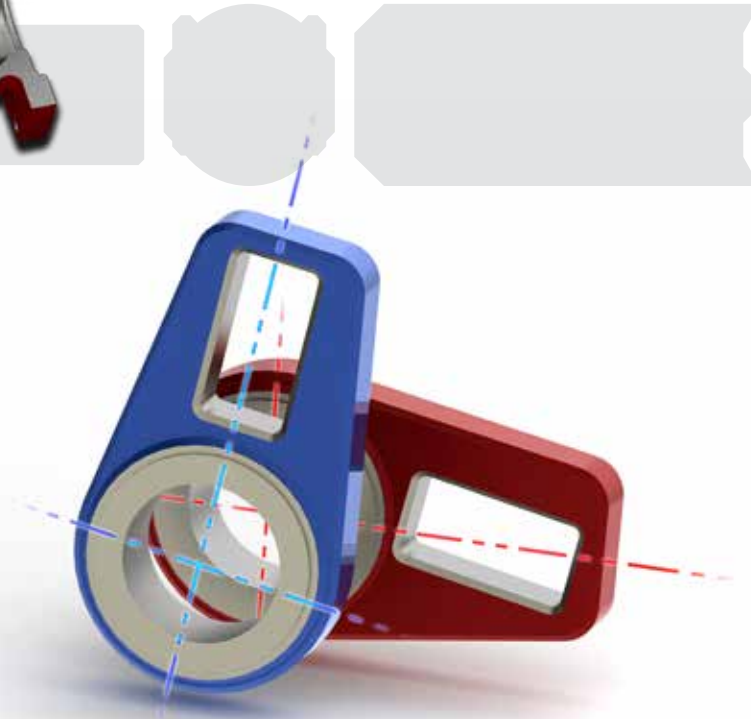

Symmetrical

The symmetrical yoke provides a balanced torque output curve. This is the best choice in applications where the torque requirements at the seat break out and end positions are similar. As the name suggests, the output torque curve is symmetrical about the mid rotation point.



Canted

The torque demands of some valve types are not the same at the break and end points. These applications call for optimizing the torque output vs. shaft angle curve. The canted yoke option shifts the torque output curve. The torque output is matched to the application requirements.



S98 Torque Curve Comparison

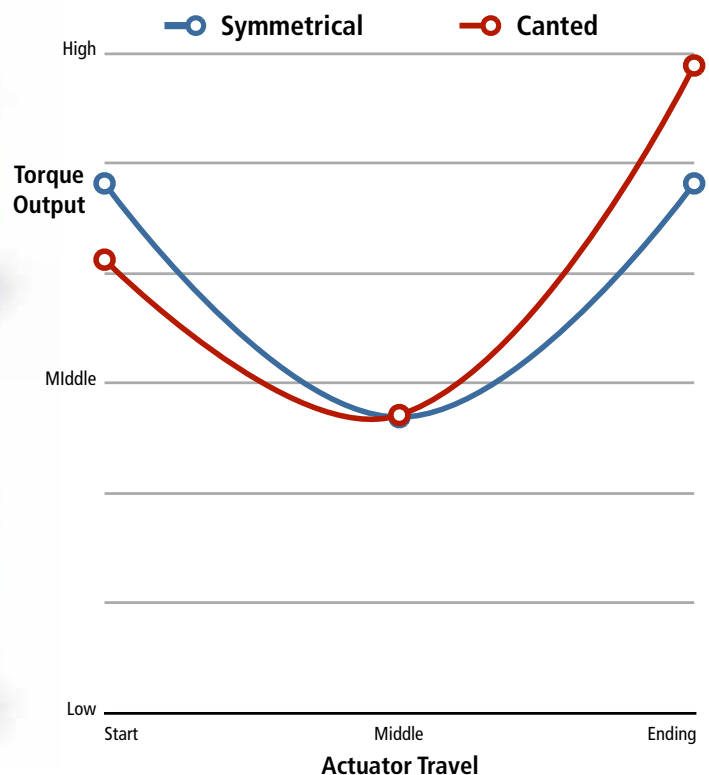

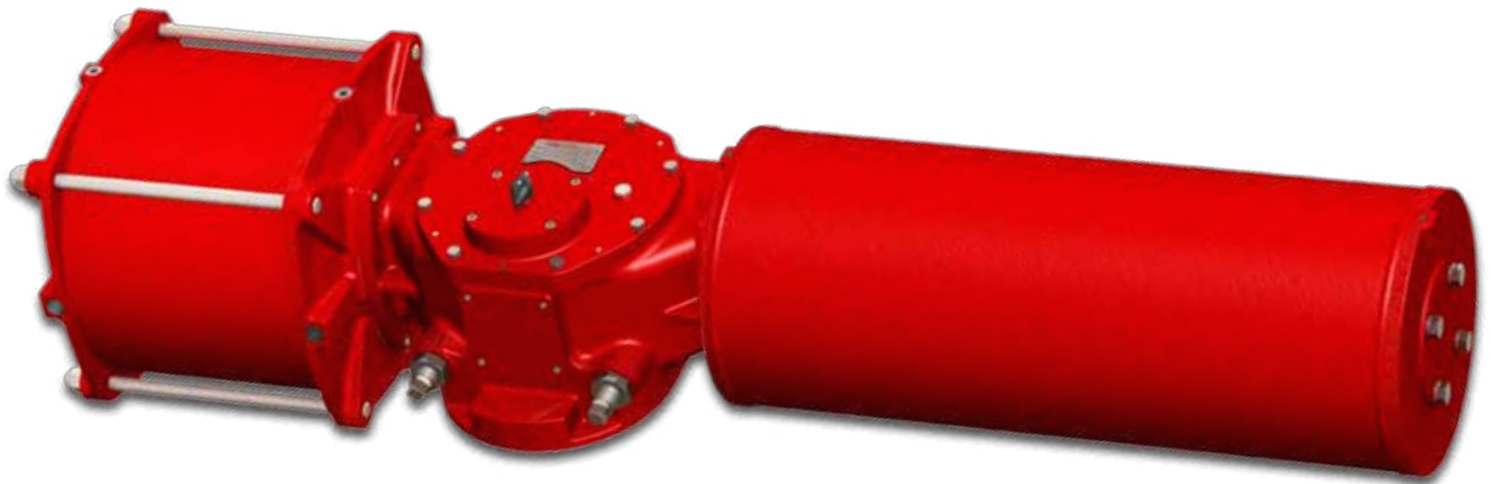

S98 Accessories

Add to the versatility of the S98 by choosing the applicable accessories from Bray's complete line of positioners, status monitors and solenoids. The combination of actuators and accessories offer the best compatibility, economy and quality performance in the flow control industry.

S6A Electro-Pneumatic Positioners

- » Precise, microprocessor driven advanced communication (HART, Profibus, Foundation Field Bus)
- » For use with both double or single acting actuators
- » Partial stroke test capable



Series 6A



Series 6A - Explosion Proof

S50 Valve Status Monitors

- » 10 amps at 125 or 250 volts AC
- » Internal travel switches that are prewired to a terminal block
- » Weatherproof or Explosion proof available



Series 50



Series 50
High Visibility Display

S52 Valve Status Monitors

- » ProxSensor provides two proximity sensors in one fully sealed, compact enclosure.
- » AC, DC, Intrinsically safe and BUS Network versions are offered.



Series 52



Filter Regulator

Solenoid Valves

- » 3-Way or 4-Way
- » Weatherproof or Explosion proof available

Filter Regulator

- » 5 micron filter designed to provide removal of solids and liquids from compressed air.

Архангельск (8182)63-90-72
Астана (7172)727-132
Астрахань (8512)99-46-04
Барнаул (3852)73-04-60
Белгород (4722)40-23-64
Брянск (4832)59-03-52
Владивосток (423)249-28-31
Волгоград (844)278-03-48
Вологда (8172)26-41-59
Воронеж (473)204-51-73
Екатеринбург (343)384-55-89
Иваново (4932)77-34-06
Ижевск (3412)26-03-58
Иркутск (395)279-98-46
Казань (843)206-01-48
Калининград (4012)72-03-81
Калуга (4842)92-23-67
Кемерово (3842)65-04-62
Киров (8332)68-02-04
Краснодар (861)203-40-90
Красноярск (391)204-63-61
Курск (4712)77-13-04
Липецк (4742)52-20-81
Киргизия (996)312-96-26-47
Магнитогорск (3519)55-03-13
Москва (495)268-04-70
Мурманск (8152)59-64-93
Набережные Челны (8552)20-53-41
Нижний Новгород (831)429-08-12
Новокузнецк (3843)20-46-81
Новосибирск (383)227-86-73
Омск (3812)21-46-40
Орел (4862)44-53-42
Оренбург (3532)37-68-04
Пенза (8412)22-31-16
Казахстан (772)734-952-31
Пермь (342)205-81-47
Ростов-на-Дону (863)308-18-15
Рязань (4912)46-61-64
Самара (846)206-03-16
Санкт-Петербург (812)309-46-40
Саратов (845)249-38-78
Севастополь (8692)22-31-93
Симферополь (3652)67-13-56
Смоленск (4812)29-41-54
Сочи (862)225-72-31
Ставрополь (8652)20-65-13
Таджикистан (992)427-82-92-69
Сургут (3462)77-98-35
Тверь (4822)63-31-35
Томск (3822)98-41-53
Тула (4872)74-02-29
Тюмень (3452)66-21-18
Ульяновск (8422)24-23-59
Уфа (347)229-48-12
Хабаровск (4212)92-98-04
Челябинск (351)202-03-61
Череповец (8202)49-02-64
Ярославль (4852)69-52-93

Единый адрес для всех регионов: bya@nt-rt.ru | | www.bray.nt-rt.ru